

# SIERRA VISTA ESTIA

# PC EXHIBIT D

**SITE PLAN**  
 CITY OF ROSEVILLE, COUNTY OF PLACER, CALIFORNIA  
 FEBRUARY, 2022

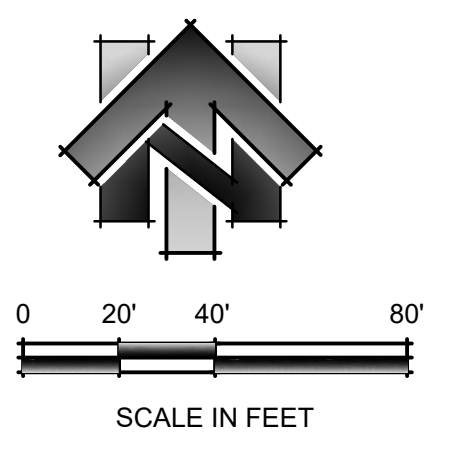

PROJECT SUMMARY	
PROPOSED ZONING	CMU/SA
PROPOSED ACREAGE	16.04 ACRE
PROPOSED UNIT PER ACRE	13 UNITS PER ACRE
OPEN SPACE / DRAINAGE - LOT A	0.55 ACRE
TOTAL ACREAGE	16.49 ACRE
1-BEDROOM UNITS	96
2-BEDROOM UNITS	113
TOTAL NUMBER OF UNITS	209
REQUIRED PARKING	390
PROPOSED PARKING	357 PARKING SPACES
ACCESSIBLE PARKING REQUIRED	36 GARAGE SPACES 7 STANDARD ACCESSIBLE 1 VAN ACCESSIBLE

**LEGEND**

PROPOSED BUILDING

PROPOSED GARAGE

**ABBREVIATIONS**

(TYP) TYPICAL

PA PLANTING AREA

ADA ACCESSIBLE PARKING STALL

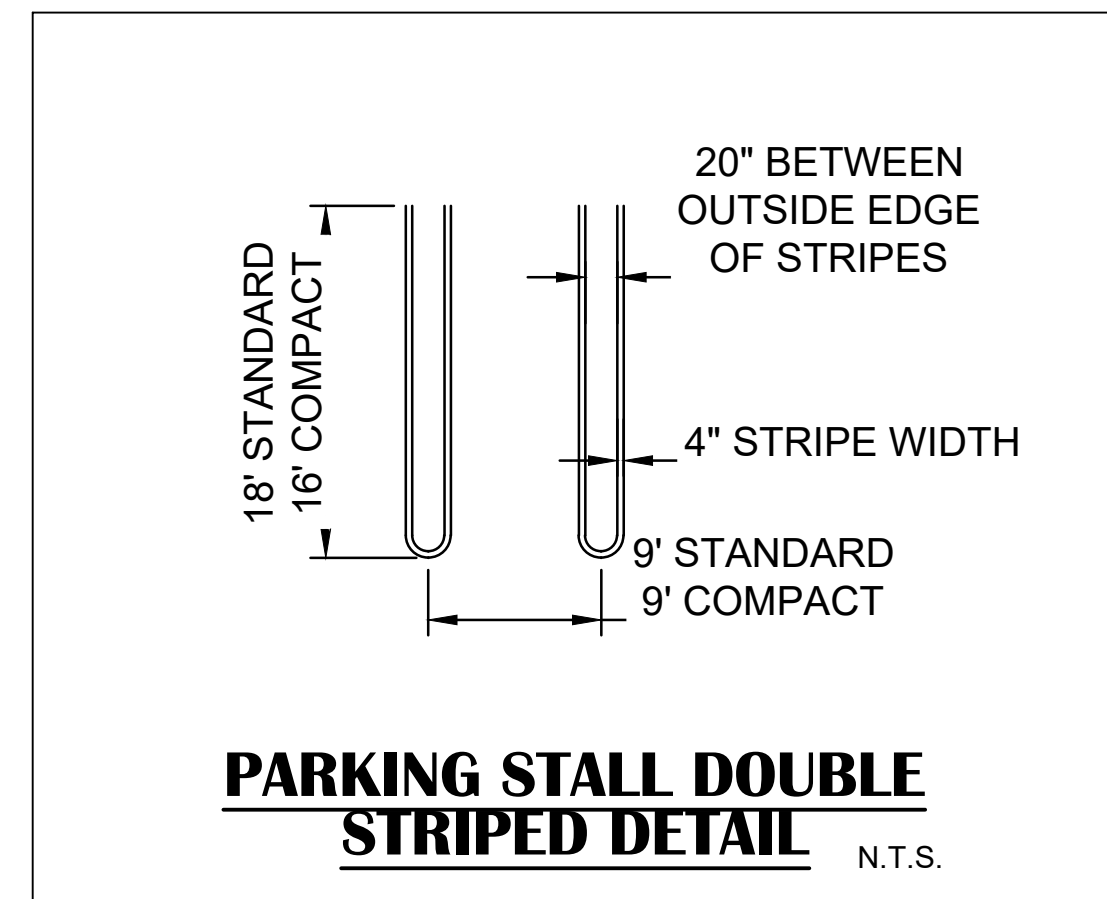
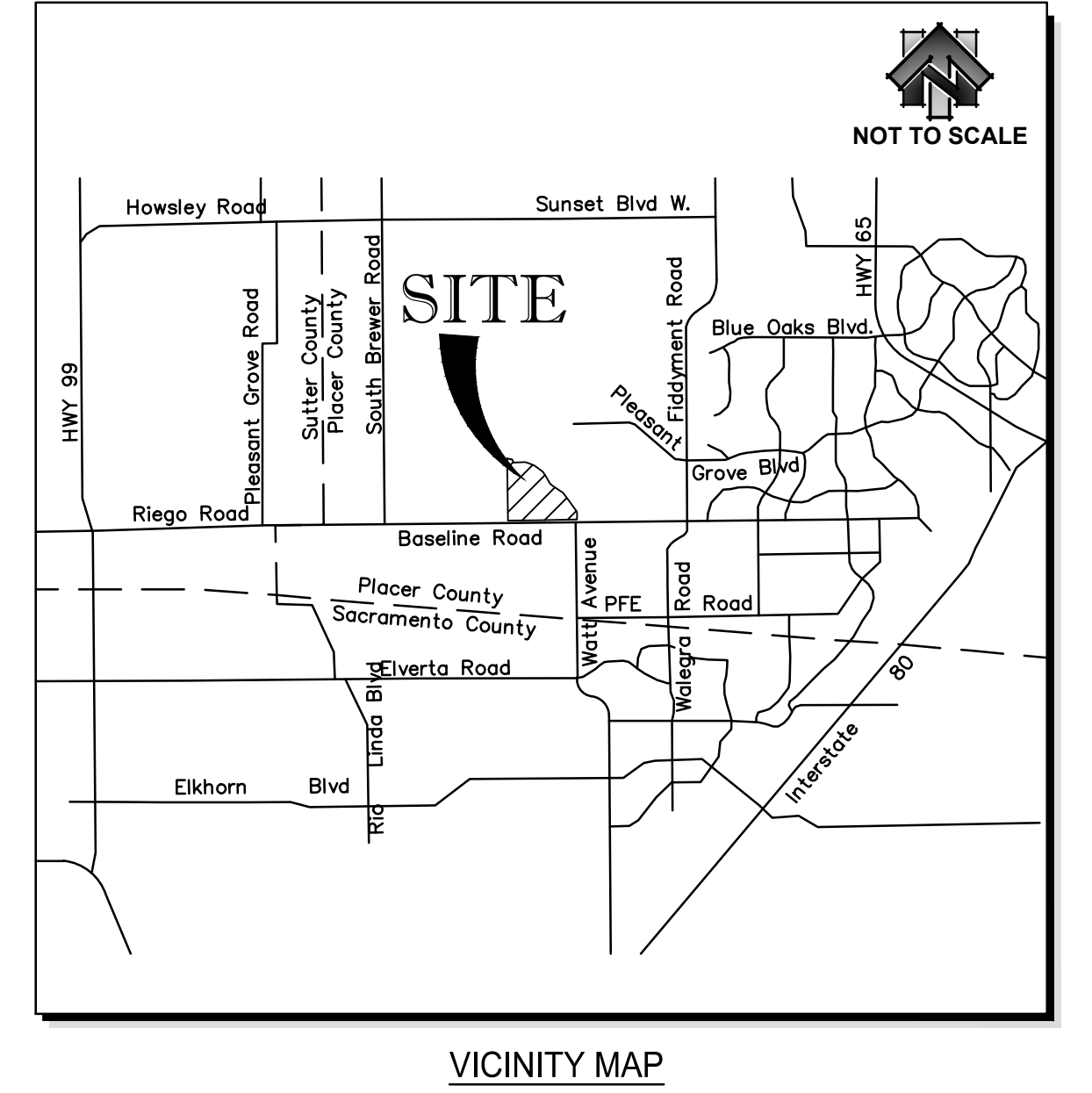

**Terrace LED E26 | 65753FSBZ**

**PRODUCT DESCRIPTION**  
 Simple, free-rotate transitional style that fits a wide variety of exterior home design. Available in both Platinum or Bronze finish. Frosted Seedy or Clear Ribbed glass, or fluorescent, incandescent or LED lamping.

**MEASUREMENTS**  
 DIMENSION: 7.7" W x 13.25" H x 8.87" Sd  
 BACK PLATE: 5.25" W x 7.75" H x 2.5" HCD  
 FINISHING WEIGHT: 5.1 lb

**LAMPING**  
 INPUT VOLTAGE: 120V  
 LUMENS: 800 lumens  
 BULB INCLUDED: 1 x FW LED E26 Medium, 9W frosted  
 DIMMABLE: No (N/A)  
 CRI: 90+ CRI  
 COLOR\_TEMP: 3000K

**FINISHES OPTION**  
 Bronze

**GLASS**  
 Frosted Seedy FS

**MATERIAL**  
 Die Cast Aluminum

**RATINGS**  
 cULus  
 Wet Location  
 Energy Star  
 JAR (JULY 17)

**ADDITIONAL**  
 INCANDESCENT WATTAGE: 60W  
 RATED LIFE: 25000 Hours  
 OPERATING TEMPERATURE: 20°C (-4°F) - 40°C (104°F)  
 PHOTOMETRIC: Report Found Online

Always consult a qualified electrician before installing any lighting product.

**WESTERN DISTRIBUTION CENTER (HEADQUARTERS)**  
 253 NORTH VINLAND AVE. CITY OF INDUSTRY, CA 91746

**EASTERN DISTRIBUTION CENTER**  
 4200 HICKORY CREEK LANSANA, CA 95316  
 P: 424.356.4200 | F: 424.356.4225 | [info@maximlighting.com](mailto:info@maximlighting.com)

**MAXIM LIGHTING**

**BUILDING LIGHTING**

**GranVille® Classic**

**Typical Applications**

- City Streets
- Parks
- Residential Areas
- Campuses
- Walkways
- Parking Lots

**Features**

- Distinctive styling
- Superior performance
- Ease of maintenance
- Permanent, durable materials
- Reliability

**Approvals**

- ULCUL

**Lamp Types**

- 35-150 watt high pressure sodium
- 70-175 watt metal halide
- 200 watt incandescent
- 55-85 watt induction (IQU)

**DRIVE AISLE AND ENTRY LIGHTING**

